

Bentley Road, Tacolneston, Norwich, NR16 1DL

Offers In Region Of £375,000

4 1 1



Moneyproperties are delighted to bring to market this spacious four-bedroom detached chalet bungalow sitting on a large corner plot in the popular village of Tacolneston. Providing versatile living throughout this home comprises of a large dual aspect living room with bay windows, a spacious kitchen, downstairs bathroom and the potential of four bedrooms depending on the purchaser's requirements. The ground floor benefits from a conservatory overlooking the rear garden. To the upstairs comes two large bedrooms and a wc off the landing. There is a well-presented front and rear garden, ample off road parking and a single garage.

Tenure: Freehold EPC: F Council Tax: D

Key Features

- Spacious and versatile chalet bungalow
- Sitting on a large corner plot
- Four spacious bedrooms with one doubling up as a dining room
- Two bedrooms upstairs with the potential of two bedrooms downstairs
- Bright and airy dual aspect living room with bay windows providing plenty of natural light
- Located in the popular village of Tacolneston
- Conservatory overlooking the rear garden
- Single garage with ample off-road parking
- Well-presented throughout, Must be viewed to fully appreciate
- Tenure: Freehold EPC: F Council tax: D

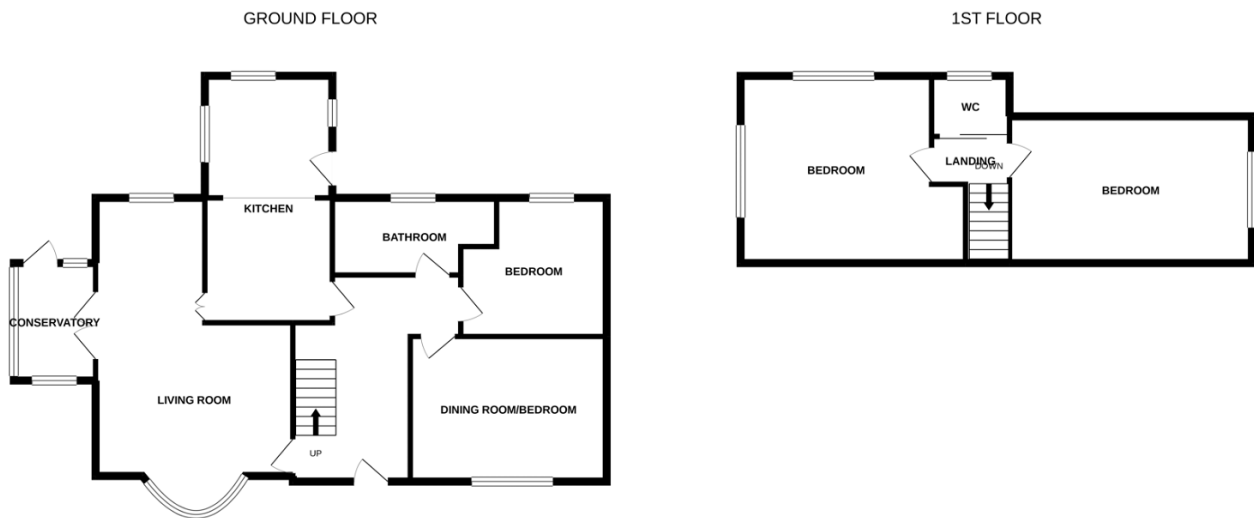

Whilst every attempt has been made to ensure the accuracy of the floorplan contained here, measurements of doors, windows, rooms and any other items are approximate and no responsibility is taken for any error, omission or mis-statement. This plan is for illustrative purposes only and should be used as such by any prospective purchaser. The services, systems and appliances shown have not been tested and no guarantee as to their operability or efficiency can be given.
Made with Metropix ©2021.